

**RIGHT ANGLE JACK RECEPTACLE FOR PCB**

**R141.665.030**

**SOLDER LEGS**

Series : **BNC-COM**

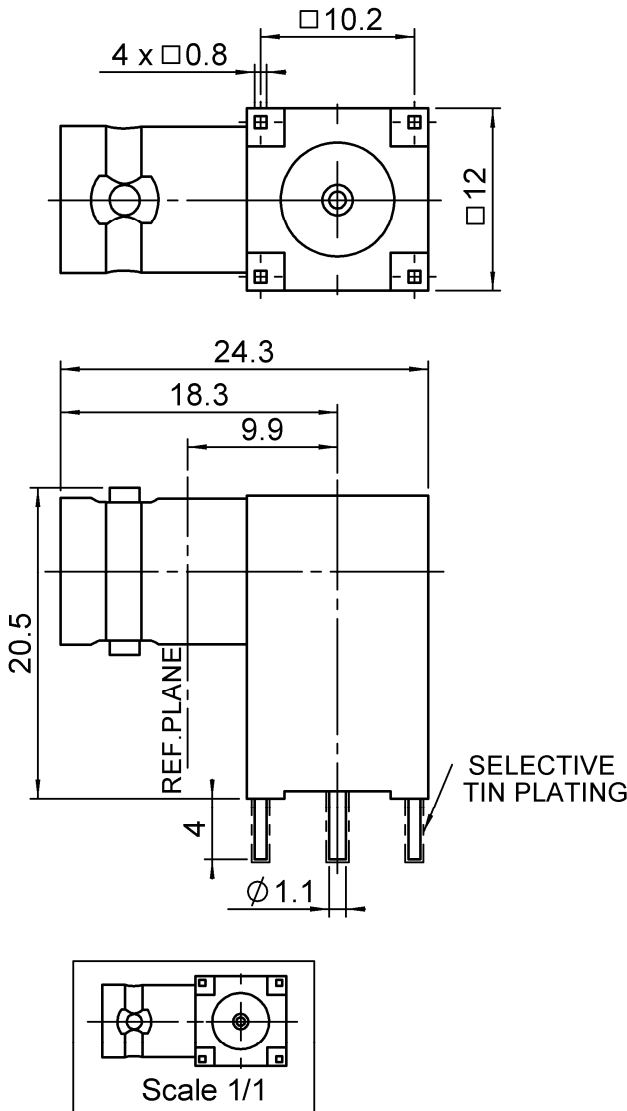

**PANEL CUT OUT**

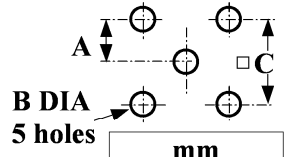

|   | mm    |       |
|---|-------|-------|
|   | Maxi  | mini  |
| A | 5.105 | 5.055 |
| B | 1.4   | 1.2   |
| C | 10.21 | 10.11 |

All dimensions are in mm.

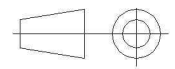

| COMPONENTS     | MATERIALS | PLATINGS (µm)       |
|----------------|-----------|---------------------|
| BODY           | BRASS     | NICKEL 2            |
| CENTER CONTACT | BRASS     | OR 0.2 SUR NICKEL 2 |
| OUTER CONTACT  | -         | -                   |
| INSULATOR      | PTFE      | -                   |
| GASKET         | -         | -                   |
| OTHERS PARTS   | -         | -                   |
| -              | -         | -                   |
| -              | -         | -                   |

Issue : 0921 D

In the effort to improve our products, we reserve the right to make changes judged to be necessary.



**RIGHT ANGLE JACK RECEPTACLE FOR PCB**

**R141.665.030**

**SOLDER LEGS**

Series : **BNC-COM**

**PACKAGING**

**SPECIFICATION**

| Standard   | Unit              | Other             |
|------------|-------------------|-------------------|
| <b>100</b> | <b>'W' option</b> | <b>Contact us</b> |

**ELECTRICAL CHARACTERISTICS**

**ENVIRONMENTAL**

|                                 |                      |                                |
|---------------------------------|----------------------|--------------------------------|
| Impedance                       | <b>50</b>            | $\Omega$                       |
| Frequency                       | <b>0-1.5</b>         | GHz                            |
| VSWR                            | <b>1.10 + 0,0000</b> | x F(GHz) Maxi                  |
| Insertion loss                  | <b>0.1</b>           | $\sqrt{F}(\text{GHz})$ dB Maxi |
| RF leakage                      | - ( <b>57</b> )      | - F(GHz)) dB Maxi              |
| Voltage rating                  | <b>500</b>           | Veff Maxi                      |
| Dielectric withstanding voltage | <b>1500</b>          | Veff mini                      |
| Insulation resistance           | <b>5000</b>          | M $\Omega$ mini                |

|                       |                |              |
|-----------------------|----------------|--------------|
| Operating temperature | <b>-35/+70</b> | $^{\circ}$ C |
| Hermetic seal         | <b>NA</b>      | Atm.cm3/s    |
| Panel leakage         | <b>NA</b>      |              |

**OTHERS CHARACTERISTICS**

Assembly instruction **NA**

Others :  
Coaxial Transmission Line Only

**MECHANICAL CHARACTERISTICS**

|                            |                |             |
|----------------------------|----------------|-------------|
| Center contact retention   |                |             |
| Axial force – Mating end   | <b>15</b>      | N mini      |
| Axial force – Opposite end | <b>15</b>      | N mini      |
| Torque                     | <b>NA</b>      | N.cm mini   |
| Recommended torque         |                |             |
| Mating                     | <b>NA</b>      | N.cm        |
| Panel nut                  | <b>NA</b>      | N.cm        |
| Mating life                | <b>100</b>     | Cycles mini |
| Weight                     | <b>22,1000</b> | g           |

Issue : 0921 D

In the effort to improve our products, we reserve the right to make changes judged to be necessary.

